

Operating Instruction 使用說明書

KITCHEN RANGE HOOD
抽油煙機

Model No.
BWR-560C



新康貿易有限公司

香港新界屯門建泰街6號恒威工業中心B1座17樓B1室

NEWIDE TRADING LIMITED

FLAT B1, 17/F, BLOCK B1
HANG WAI INDUSTRIAL CENTRE,
6 KIN TAI STREET, TUEN MUN, N.T.

Tel : (852) 2461 1223 | 2462 5223 Fax : (852) 2469 2882

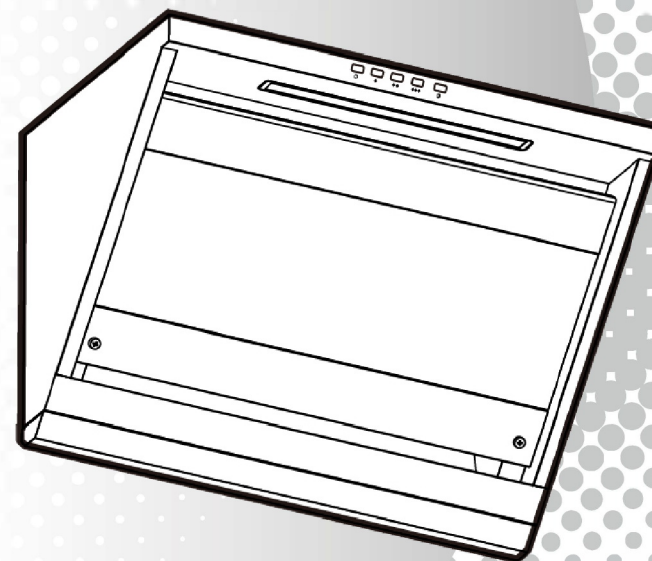



Thank you very much for purchasing Bondini product.
非常感謝您購買了Bondini產品。

 Before operating this range hood, please read these instructions carefully and completely, paying special attentions to notes pertaining to your particular model.

在使用此抽油煙機前，請仔細閱讀全本使用說明書，並留心有關型號的注意事項。

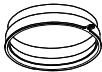
Accessories 附屬配件

名稱 Name	簡圖 Sketch	數量 Qty.
風管圈 Exhaust Pipe		1
說明書 Instruction		1

CONTENTS 目錄

1 安裝原則	2
PREPARATION FOR INSTALLATION	6
2 安裝施工說明	3
INSTALLATION PROCEDURE	7
3 使用方法	4
OPERATION OF YOUR MACHINE	8
4 使用注意事項	4
SAFETY GUIDE	8
5 保養	5
MAINTENANCE	9
6 異常狀況之處理	5
TROUBLE SHOOTING	9

*The illustration in this booklet is just for reference, real machine status should be considered.
本說明書內示意圖樣僅供參考，實際以實體為主。

Dear Customers 親愛的顧客

- Thanks for purchasing Range Hood. We are always glad to offer you quality service as well as best improvements at noise and wind-exhaust efficiency.
(In order to let you more enjoyable and safer by using our machines).
- 謝謝您的惠顧，讓我們有機會為您府上提供抽油煙機產品，本系列產品除維持一貫服務品質外，並針對噪音、排油煙力等問題加以改良讓您用得舒適、更安心。
- Any questions is considered about our products or for further services, kindly please contact service department of our agent.
- 若對本產品有任何使用上的疑問，或需要服務的地方，請洽代理商服務部。

⚠ CAUTIONS 注意

- This appliance is not intended for use by persons (including children) with reduced physical, sensory or mental capabilities, or lack of experience and knowledge. Unless they have been given supervision or instruction concerning use of the appliance by a person responsible for their safety.
- Children should be supervised to ensure that they do not play with the appliance.
CAUTION: Accessible parts may become hot when used with cooking appliances.
- 本裝置不適合供給肢體、智能、行為能力或是精神狀態有障礙的人使用(包括孩子)，除非他人給了他們關於對裝置的用途的監督或指示，並對他們的安全負責。
- 孩子應該被監督以確保他們不使用並把玩該裝置。
- 注意：當烹調器具在使用時，容易接近的零件也許變得熱。

1 安裝原則

1 安裝抽油煙機之附近範圍，應避免有過多門窗而產生太大空氣對流，影響本機之排煙效果。

2 當抽油煙機與其他煮食爐同時操作時，請保持室內空氣流通。

3 抽油煙機安裝於爐具之正上方。

4 安裝後之機體不應歪斜應保持水平，否則集油杯內積油將傾向單邊而溢出機體外。

5 排風出口至機體之距離，應盡量避免過長，以免氣流擠壓於管內，影響其排風效果。

6 抽油煙機之安裝高度是以爐面至機體下方之距離為準，參考高度為 30-35cm。

7 排風管安裝時，不得與其他氣體燃氣爐具之排放口安裝在同一煙囪之通道內。

8 固定抽油煙機時，需將螺絲鎖緊固定於牆上，不可將油機掛在螺絲上。

1 門窗過多，對流太大



3

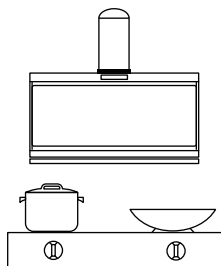

4 保持水平

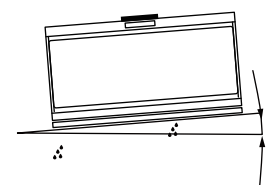

6

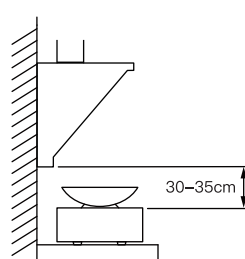

Parts Identification 圖解

Diagrammatic Sketch 示意圖

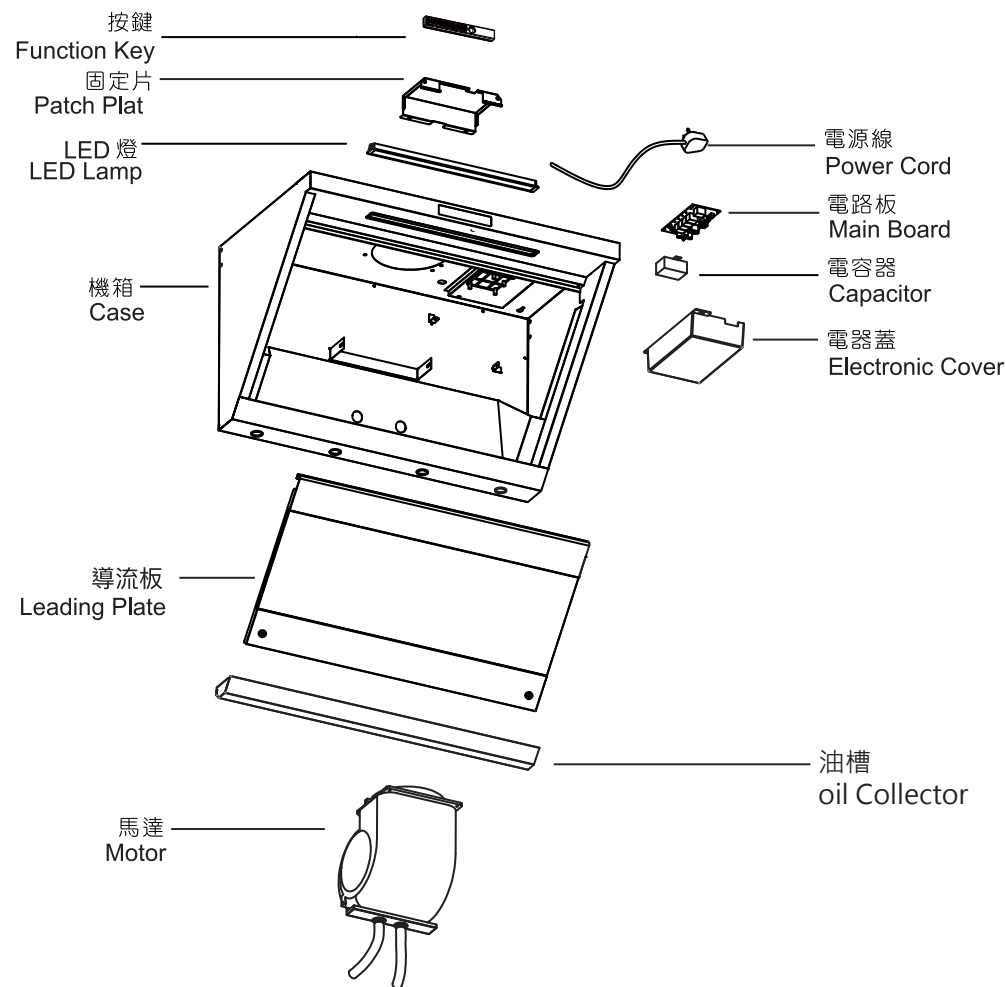

Circuit Diagram 配線圖

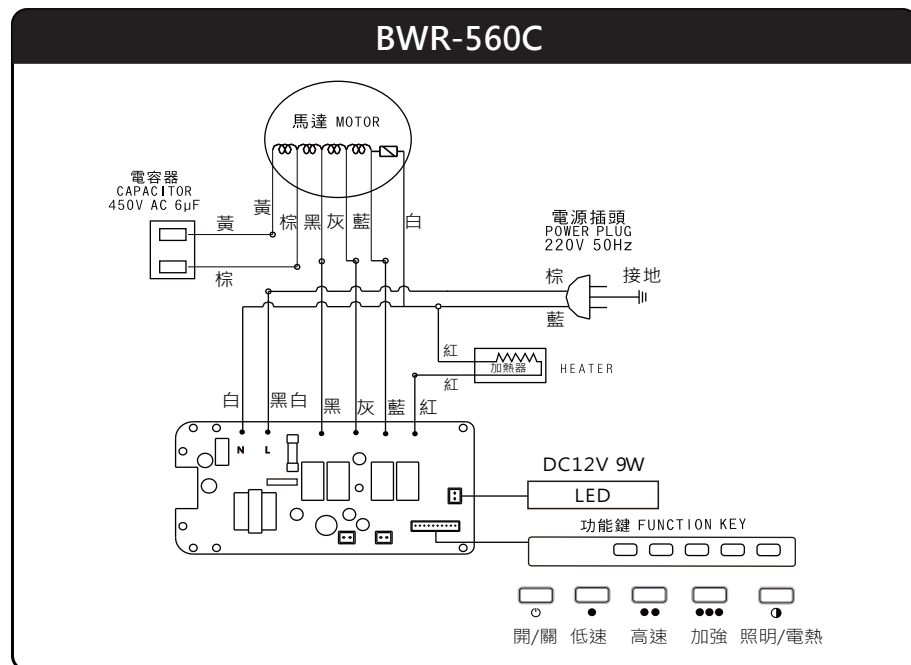

IC全自動全功能記憶電洗除油

每次使用完關機後，IC全自動記憶使用時間，在累計使用超過30分鐘以上，關機後 Clean 閃爍15分鐘(註▲)+2分鐘(註▼)。

手動智能全功能電洗除油

因應個別人仕及個別情況需求，可手動操控智能電洗除油功能，只需按壓開/關/電熱2秒以上，閃爍15分鐘(註▲)+2分鐘(註▼)。

(註▲) IC全自動加熱15分鐘洗黏於風箱油槽內壁油煙。

(註▼) 風扇運轉2分鐘電洗所有溶掉油煙並排到油杯上。

2 安裝施工說明

1 打開紙箱檢視保證書、說明書、排風管和風管座等附屬配件是否齊全。

2 安裝前先接上電源，測試按鍵上之各項功能是否正常運作(馬達運轉、照明)。

3 在已選定的安裝位置上，以1/4"鑽頭鑽孔，將孔塞(俗稱塑膠栓)塞入孔內，並於配合吊鐵鑰匙孔之孔位鎖上螺釘。

4 調整機體兩側之掛鉤(吊鐵)，將機體懸掛於螺釘上，懸掛後，必需於吊鐵圓孔處再鎖上一螺釘與牆壁固定。

5 懸掛後，機體要保持一定水平。
(安裝原則裡第3項已敘述)

6 排風管之安裝位置：
(一)選擇最近可通向室外之窗戶，裝設排風管穿窗而出。
(二)或選可通向室外之牆壁(非隔間牆壁)打洞，裝設排風管穿牆而出。

7 裝設排風管：
■ 將排風管之一端套入合適之風管座，並將風管座端固定於機體出風口及排風管另一端固定於排氣孔上。

8 裝設風管蓋選配)：
■ 鎖上風管蓋兩側之螺絲。
■ 調整所需高度並將風管蓋固定片鎖上所需位置。
■ 將風管蓋拉長至所需高度，並以螺釘將其鎖在固定片上。

註：有關排風管之裝設，以上說明僅供參考，施工需請專業人員處理或洽代理商。

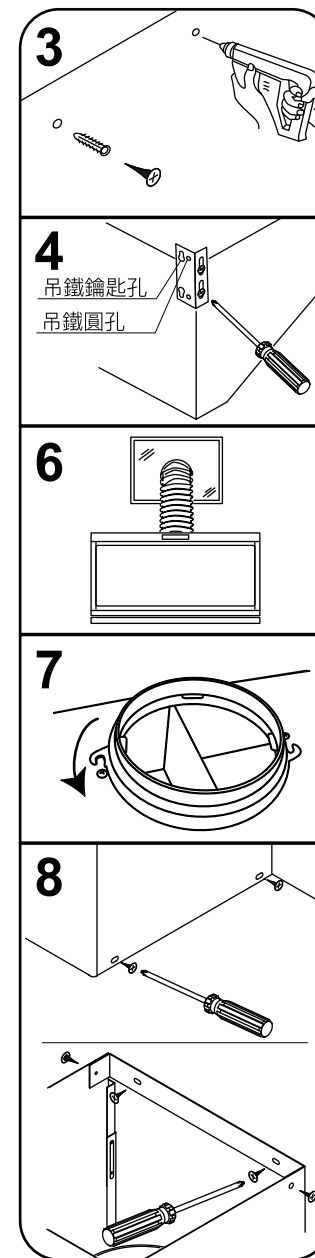

3 使用方法

1 開始使用時，可依所需觸按機體前方之開關按鈕。

按鍵說明



- 按『開關』鍵，本機會開始運作，長按2秒鐘則會啟動延遲關機功能，90秒的低速運轉後停機。
- 若使用時間累計超過30分鐘，電熱除油功能會自動開啟，15分鐘後會停止加熱，而馬達再轉動2分鐘後停機。
- 按住『照明』鍵2秒後，會啟動電熱除油功能。

2 集油杯之裝拆：

- 當集油杯內所盛之油汁已達八分滿，將油污倒掉，然後用中性清潔劑清洗，再裝回原固定位置。
- 集油杯取出時，用手將集油杯略抬高並拉出，裝回時將集油杯置之集油槽中，推入至底即可。

3 清潔方法：

- 清潔時，內外表面可用軟布沾中性清潔劑擦拭，避免刮花機體及導流板內外表面。



注意

• 清潔抽油煙機前應先拔下插頭。請檢查底板上掛鉤與機體的連接是否牢固，以策安全。

4 使用注意事項

1 電潔插座必須安裝接地線。

2 清潔抽油煙機前應先關掉電源。

3 抽油煙機使用時，可將大部分油煙抽出室外，故此油杯油污存量很少。

4 請勿直接潑水噴淋機體以免損壞電器機件。

5 Maintenance

1 Good maintenance allows the best performance of the machine and prolongs it's operation life. Please take good care of your machine.

2 Turn off power supply before maintenance.

A. Always keeps machine clean.

- After each use, please wipe machine housing and bottom cover plate with a dry cloth or a wet cloth with mild detergent.

B. Empty dirty oil cup when it is 80% full of oil, to avoid overflow.

6 Trouble Shooting

- When there is a problem with the machine and is unable to solve by user, turn off the machine and contact service centre.
- Disconnect the power supply whenever there is a malfunction phenomenon.

Status	Causes and Methods of Repairing
Power supply cord is broken	<ul style="list-style-type: none">• Please contact our service centre.
The bulb works but the motor doesn't run	<ul style="list-style-type: none">• Please contact our service centre.
Oil leaks from the housing cover	<ul style="list-style-type: none">• Check if the oil cup is full.• Check if the oil cup is broken, or it is in right position.
Machine vibration	<ul style="list-style-type: none">• If the machine is screwed tightly.• If the machine is in level position.
Suction becomes weak	<ul style="list-style-type: none">• The distance between range hood and range top is too far away.• Too many doors or windows around the hood to cause convection.• The machine is installed at front of window.• Please refer to the Installation Procedures and Safety Guides for good installation.

3 Operation of Your Machine

1 Press switch for function as required:

Operation

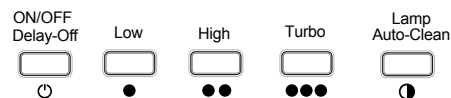

- Press the **ON/OFF** button, the machine operates of high speed.
- When the machine operates over 30 mins, the electrothermal auto-clean function will start to operate for 15 mins then the motor operates 2 mins. The 30 mins is an accumulate figure .
- Press the **LAMP** button for 2 seconds, the electrothermal auto-clean function will start to operate for 15 minutes.
- Press the **ON/OFF** button for 2 seconds, the motor will start to operates for 90 seconds then **OFF**.

2 Installation and Dismantling of Oil Cup :

- Empty oil cup when it is more than 80% full. Pour out dirty oil and clean th cup with detergent, then put it back to its original position.
- To remove oil cup, hold the handle and pull forward along the slot. Reserve the procedure to put it back.

3 Cleaning :

- Use soft cloth to clean the inner and outer surface with mild liquid detergent and then wipe with wet cloth. Avoid using any harsh brush to rub the machine body.

! CAUTIONS

- Make sure that the lower bottom cover is securely hooked with the hood body.

4 Safety Guide

- 1 The range hood must be earthed.
- 2 Disconnect power supply before cleaning the hood.
- 3 Most of soot will be exhausted through the pipe to outdoor when range hood is in operation, so only negligible oil with be left in the oil cup.
- 4 Do not splash or spray the range hood with water, the machine may damage.

5 保養

- 1 為發揮本機最佳性能，延長其使用壽命，應經常注意保養。

2 保養維修時應將插頭拔掉，切斷電源！

(一) 清潔機體：

- 常保機體外部潔淨，使用後請用乾布或沾有中性清潔劑之抹布，擦拭機體外殼與導流板，經常保持乾淨以維護其美觀及衛生。

(二) 清除積存之油污：

- 當油杯內所盛之油汁已達八分滿，需將油汁倒掉，以免溢出。

6 異常狀況之處理

- 使用中發現異常狀況時，如未能自行解決問題，請將開關電源和拔掉插頭，並聯絡維修中心服務。
- 處理異常狀況時，請先拔掉插頭。

狀況	原因及處置方法
電源線損壞	• 請聯絡維修中心。
燈亮馬達不轉	• 請聯絡維修中心。
底板漏油	• 油杯是否滿溢。 • 油杯是否有破裂，油杯安裝是否妥當。
機動震動	• 查看機身是否安裝妥當，沒任何鬆脫。 • 查看機身安裝是否左、右方高低不平。
吸力不強	• 抽油煙機與爐面的距離太高。 • 抽油煙機周圍環境門窗通風多，對流太大。 • 抽油煙機裝置在窗戶處。 • 參考安裝原則及安裝注意事項進行安裝。

1 Preparation for Installation

1 If there are too many windows and doors in the kitchen, convection may cause and it will downgrade the performance of the machine.

2 Maintain adequate ventilation of room when the range hood operate with gas or electric stove and other heating appliances at the same time.

3 Machine shall be installed on wall or underneath a cabinet.

4 The machine must be in level position, otherwise grease in oil cup may leak.

5 Distance between exhaust vent and machine shall be suitable and kept as short as possible so that the efficiency of exhaustion will not be affected.

6 Keep a distance of 30-35cm between cooking surface and the front hood of the machine.

7 Exhaust vent must not be discharged into a duct which is used also for other cooking or heating appliances.

8 Range Hood must be installed by firmly attaching to solid wall with screws.

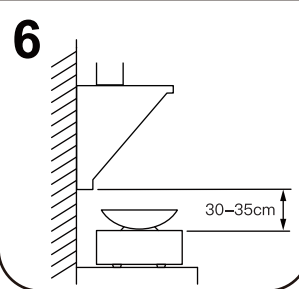
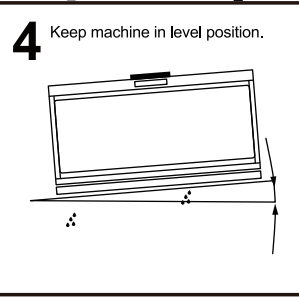
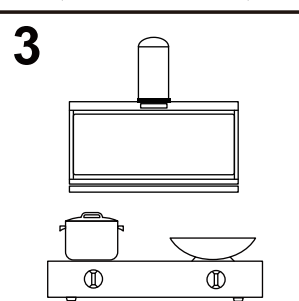

2 Installation Procedures

1 Check if warranty card, instruction booklet, pipe adapter and so forth accessories are in carton box.

2 Before installation, check every functions of each switch are in good condition (such as motor running, illumination).

3 Select suitable position for installation, drill hole on the wall by using 1/4" thread bit and put screw lock inside the hole to fit screw with matching hanging hole.

4 Adjust hangers of both sides, hang machine onto screws and the fixing holes must be screwed on the wall.

5 The machine must be in level position.

6 **Installation position of Exhaust Vent :**
 ■ Exhaust vent must attach and penetrate the closest window above the machine.

7 **Installation of Exhaust Pipe :**
 ■ Insert one side of exhaust pipe to the adapter fitted on the top vent of machine. Then, another side of pipe is fitted to go through exhaust hole.

8 **Installation of Duct Cover (alternative) :**
 ■ Secure it with the Duct Cover screws provided. Adjust the mounting bracket to your desired height.
 ■ Drilling hold on the wall by using 1/4" thread bit, secure the mounting bracket with screws provided.
 ■ Slide the Duct Cover into the unit and adjust it's height, secure Duct Cover with the screws provided.

Note and Importance :

- Installation must carry out by a qualified and licensed technician.

